



3 Way Ball Valve

Features & Benefits

Using FULL FLOW, floating ball valve technology, the Oasis dispensing valve will redefine the flow rate standard for NGV gas delivery.

Using the proven LOWEST LIFE COST valve design, the dispensing nozzle can be re-kitted numerous times. Spare part kits are readily available and easy to install. Visit www.OasisNGV.com to view maintenance instructions.

Fully machined from stainless steel bar stock, with either 45 degree or 90 degree porting.

Black handle (pictured) optional.

Our unique patented design eliminates cross venting between the "fill" and the "vent" positions. This reduces the volume sent to the vent line, ensuring a safer and more efficient filling system.

World wide patent pending

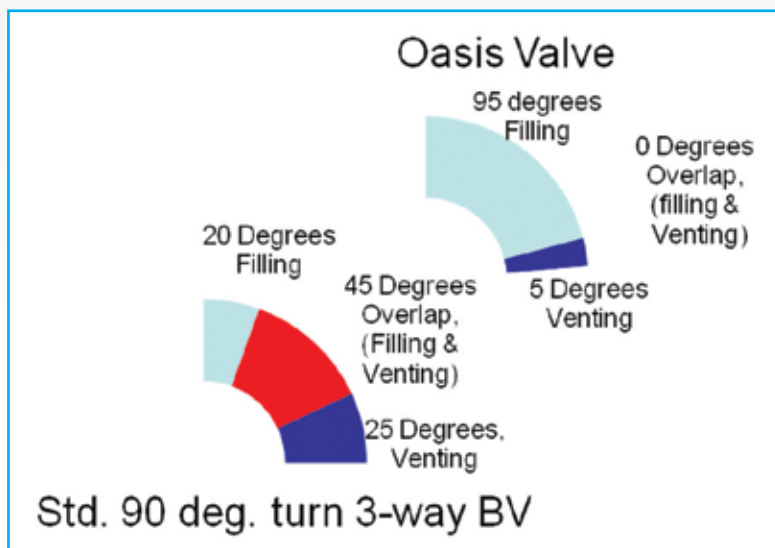

With the FULL FLOW design, this means more gas is dispensed, faster, to the vehicle maximizing number of vehicle fills per day.



3 Way Ball Valve

Application & Specification Information

CNG Dispensers.

CNG Trailers load/unload systems.

Dimensions stated below are for complete valve assembly, excluding nozzle connections.

P30 profile nozzle, custom nozzle and 7/16 probe are available and quoted separately.

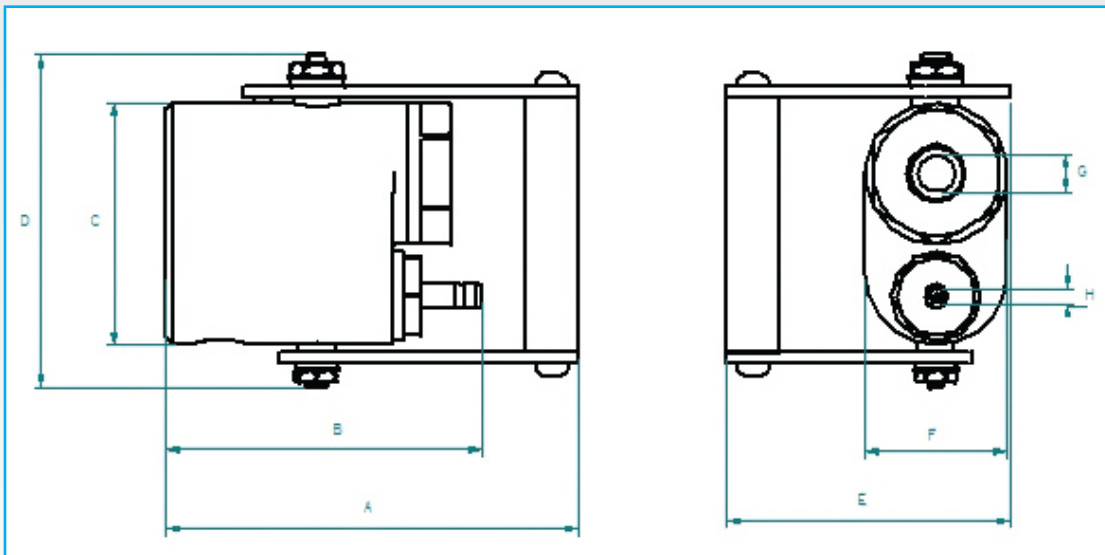
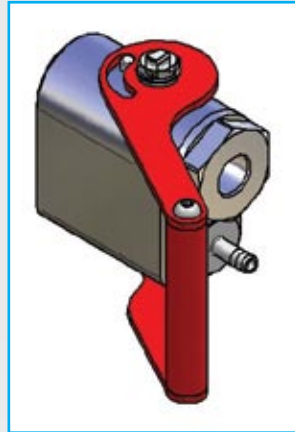

Dimensions (mm)

Part Code	A	B	C	D	E	F	G	H	C _v *	K _v **
TV103	111	85	65	89.7	76	38	10	2	12.93	11.15

* C_v = USGPM-PSI

Note: C_v & K_v factors are for straight ported valves.

** K_v = M3/hr-BAR

Operating pressure range from 7 PSI to 6000 PSI.

Vent line from 7 PSI to 6000 PSI.

Burst Pressure > 20,000 PSI.

NPT Female is standard quoted thread on inlet & outlet ports. Other options available.

1/4" tube for 1/4" ferrell fitting with 3/8" BSP threaded fitting supplied for vent line

All products are manufactured under ISO 9001:2000 accredited standards.

Delrin/Nitrile seat configuration MAWT 120° c. Other material options available upon request.