



700 Series Panel Mount

Features & Benefits

Utilising the proven LOWEST LIFE COST of Oasis Ball Valves.

Bracket spaced to allow straight tube work behind panel.

Simple re-kitting procedure utilising standard valve seal kits.

Supplied assembled or kit-set.

Full range of valves, thread options and tube lock configurations available.

Cast aluminium handle giving superior durability.



Materials

ITEM	DESCRIPTION	MATERIAL
1	Ball valve & mounting bracket	Valve as per specification. Bracket in 304 Stainless steel
2	Panel Mount Body	T304 Stainless steel*
3	Panel mount stem	T304 Stainless steel*
4	Spacing washer	Aluminium
5	Mounting nut	T304 Stainless steel*
6	Segment	T304 Stainless steel*
7	Handle	Aluminium

* T316 Stainless steel available on request.

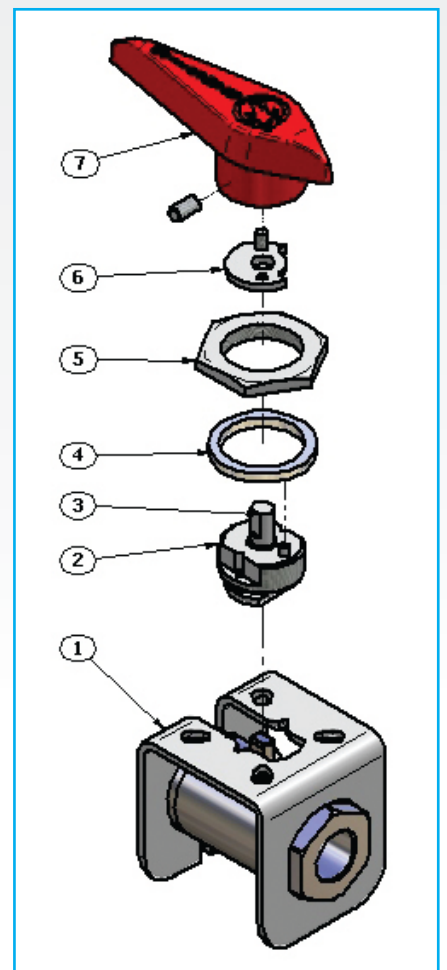

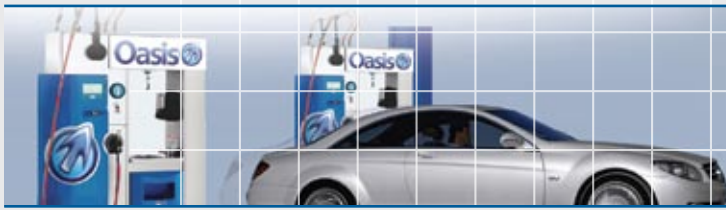

700 Series Panel Mount

Application & Specification Information

- CNG Dispenser Isolations.
- CNG Control & Priority Panels.
- Trailer and Transporter Panels.
- Any locked cabinet.

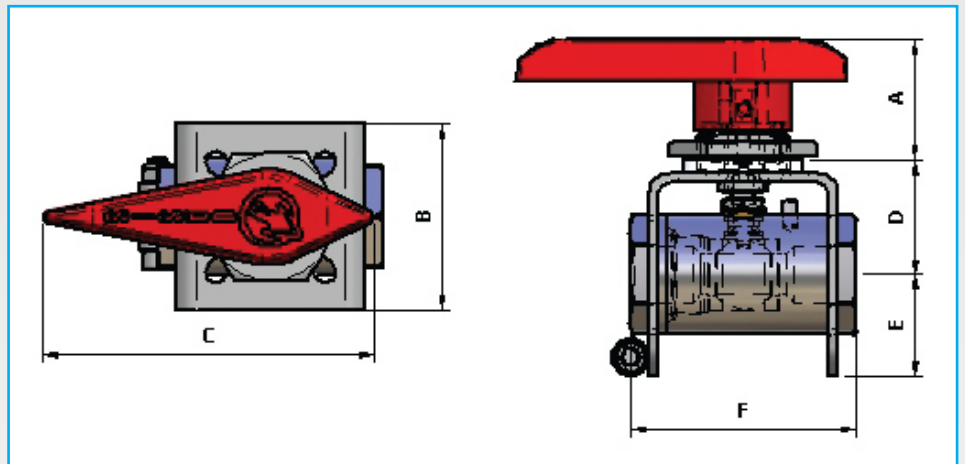

Dimensions (mm)

Part	Valve size	A	B	C	D	E	F
BV703	3/8"	39	65	105	35	28	59
BV704	1/2"	39	60	105	37	33	72

Valve specifications as per relevant specification.

Full range of valve thread options available.

Panel mounted options available for other diameters on request.

Valve to panel offset (dimension D) can be user defined.

Pricing includes valve, bracket and handle.

All products are manufactured under ISO 9001:2000 approved standards.

