



BV700 Series Ball Valve SAE Instruction Manual

▲ WARNING

Failure to follow these instructions or to properly install and maintain this equipment could result in gas leakage, fire or explosion causing property damage and personal injury or death.

Oasis products must be installed, operated and maintained by trained and competent personnel in accordance with all applicable local codes, rules and regulations in addition to the Oasis Instructions.

Oasis Engineering Ltd. will not be held liable in such circumstances where installation, operation and maintenance procedures were performed by incompetent personnel resulting in improper assembly, unsafe operation, equipment damage or personal injury.

Oasis recommends that all service technicians should watch the Product Servicing Video before attempting to service this part.



Servicing Video

Oasis Engineering Ltd
129 Birch Avenue, Tauranga, New Zealand.
T: +64 7 928 3808
E: info@oasisngv.com
W: www.OasisNGV.com



Instruction Manual

Warning!

High pressure gas and gas equipment can cause serious harm to both infrastructure and personnel if safety precautions are not followed.

Oasis recommends considering the use of the following PPE when working with high pressure along with any other site specific health and safety requirements:



Foot Protection



Hearing Protection



Safety Helmets



Hand Protection



Safety Glasses



Ensure the system is clean of debris, vented and isolated before any installation or servicing work is carried out.

Tools Required

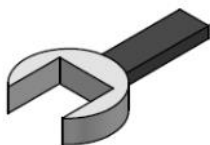

Spanner
(Wrenches)



Thread Tape



Anti Seize Grease
- Swagelok Silver Goop
- Omega 99
- or similar



Silicone Grease
(Rocol MX22 or similar)



Spray bottle
(Snoop or soapy water)

1. Apply anti seize to thread and silicone grease to the O-ring. Install the O-ring on the fitting if not pre-installed.

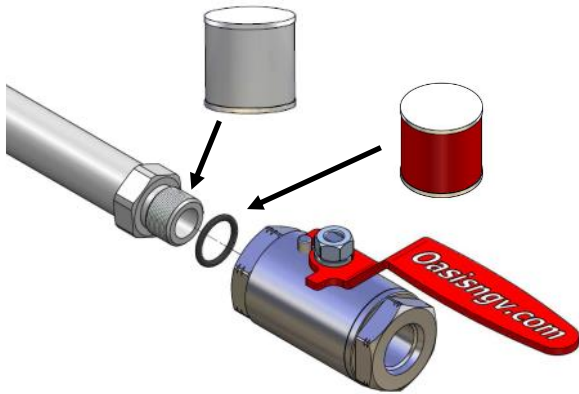

2. Screw the fitting into the body and torque to the fitting suppliers recommended tightening torque.

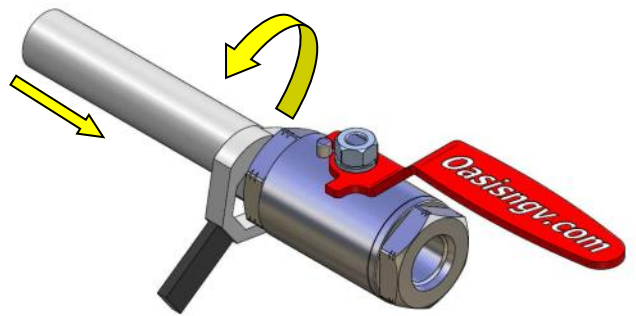

3. Apply anti seize to thread and silicone grease to the O-ring. Install the O-ring on the fitting if not pre-installed.

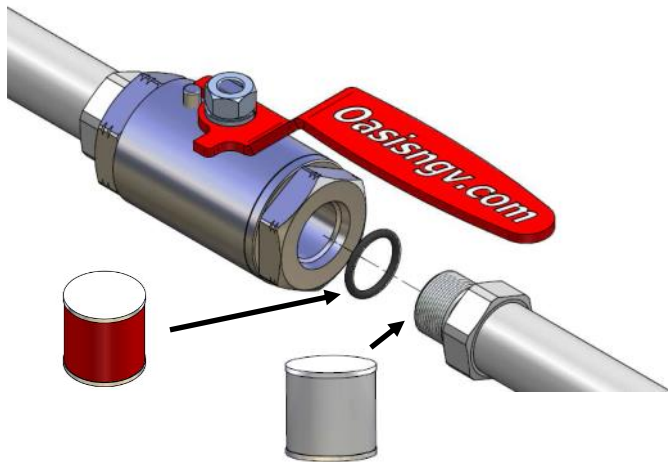

4. Screw the fitting into the body and torque to the fitting suppliers recommended tightening torque.



5. Correctly tightened SAE port fittings should bottom out on the port face and the O-ring should neatly fill the void creating the seal.

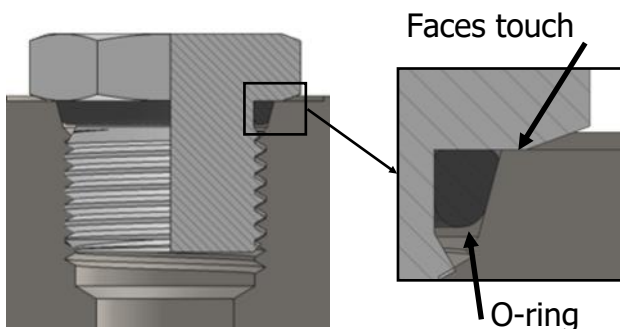

6. Assembly is complete, check for leaks on first use with Snoop or soapy water.

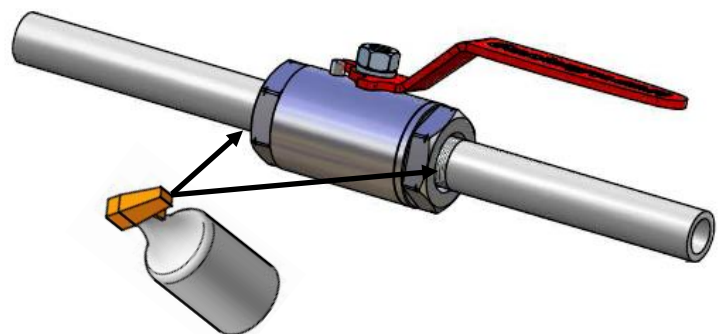

1. Closed

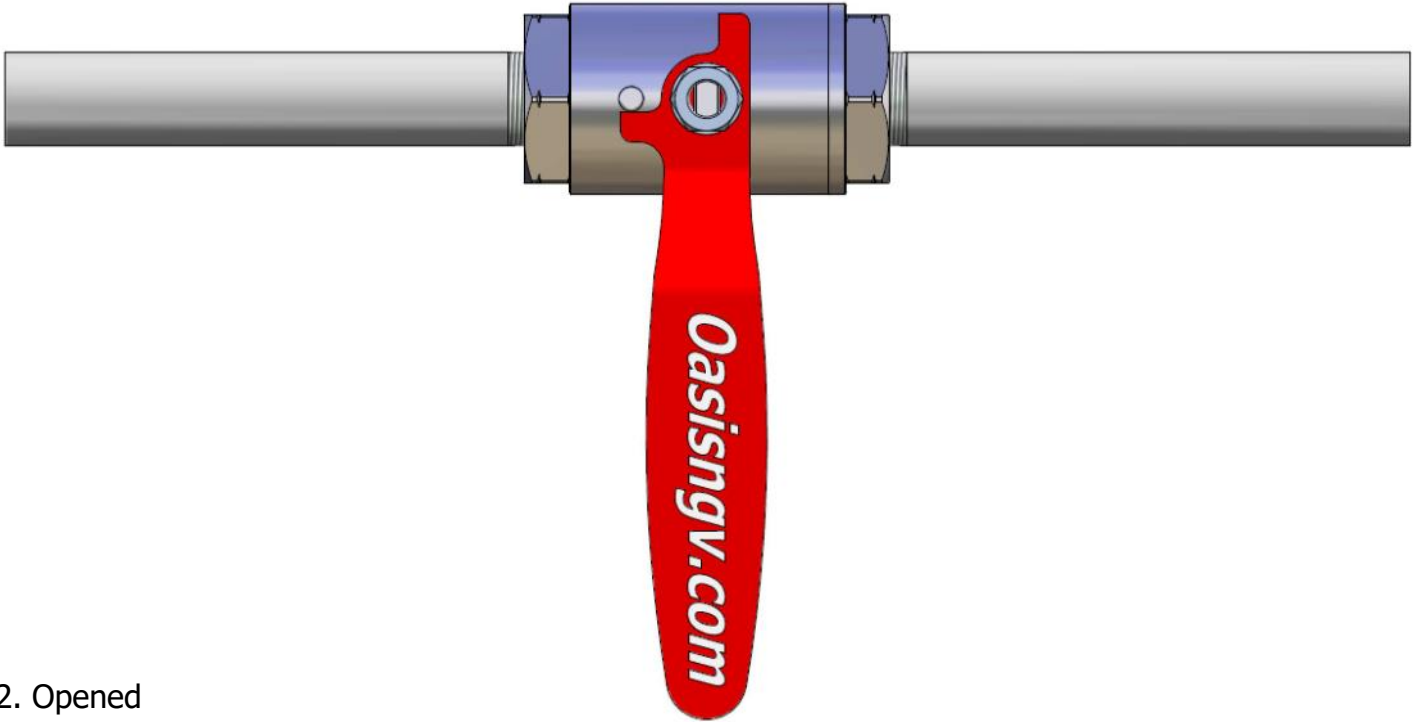

2. Opened

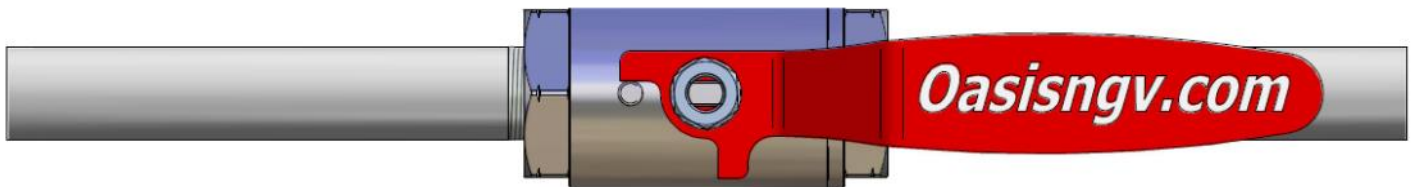

Important: Actuate valve 4 times before use to ensure initial sealing.

**Recommended Spanners
for End Caps:**

- BV702 = 25mm**
- BV703 = 28mm**
- BV704 = 34mm**
- BV706 = 50mm**
- BV708 = 60mm**
- BV710 = 66mm**
- BV712 = 79mm**

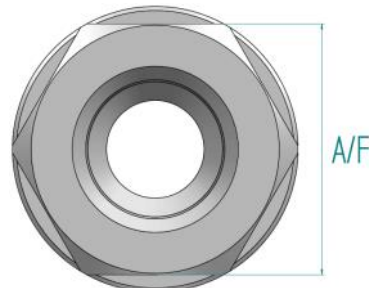

Service Kit Parts

BV704

2 x Seats[^]



1 x Stem



1 x Ball



1 x Gland



1 x Silicone



1 x Cap O-ring



1 x Locking Tab*



2 x SAE Fitting O-ring

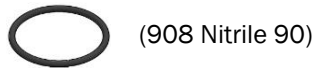

(908 Nitrile 90)

BV706 — BV708

2 x Seats[^]



1 x Stem



1 x Ball



1 x Gland



1 x Silicone



1 x Cap O-ring



1 x Locking Tab*



1 x Cap Backup O-ring



2 x SAE Fitting O-rings



* only used when servicing actuated ball valves.

It is normal for the service kit to include a ball with a small hole in the bottom.

[^] For low pressure service kits, the seats will be supplied with an O-ring installed.

The Complete Oasis Seal Kit must be used

Tools Required

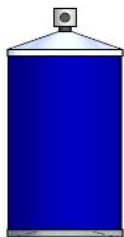

Cleaner (Warm Soapy
Water or Similar)



Pick Tool
Part Number:
TOOL-PICK
(Sold separately)



Anti Seize Grease
(Loctite 771 or Similar)
For All Threads

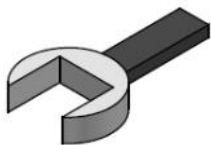

Spanner
(Wrenches)

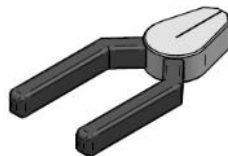

Pliers



Oasis Plastic Tool
Part Number:
TOOL-BVASSY
(Sold separately)
or Similar

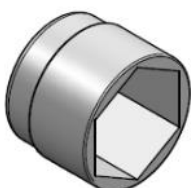

Sockets

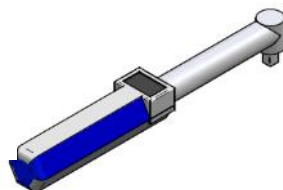

Torque Wrench

1. Undo handle nut.

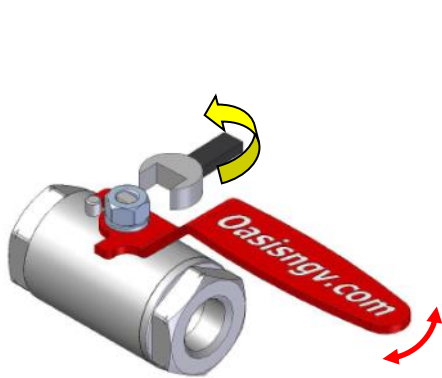

Open and close valve to ensure all trapped gas is released.

2. Remove handle.

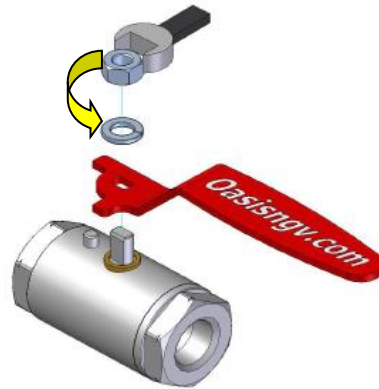

3. Discard gland.

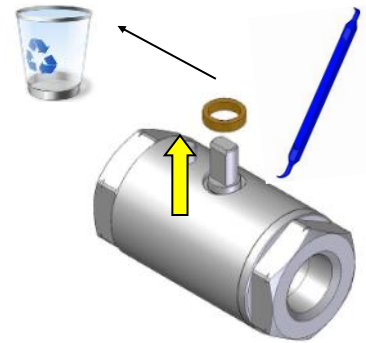

4. Remove end cap.

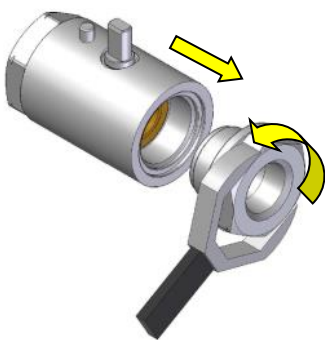

5. Discard seat.

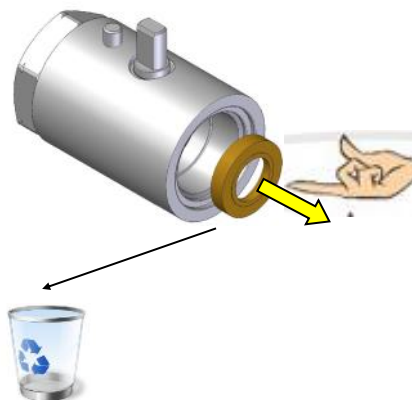

6. Remove ball.

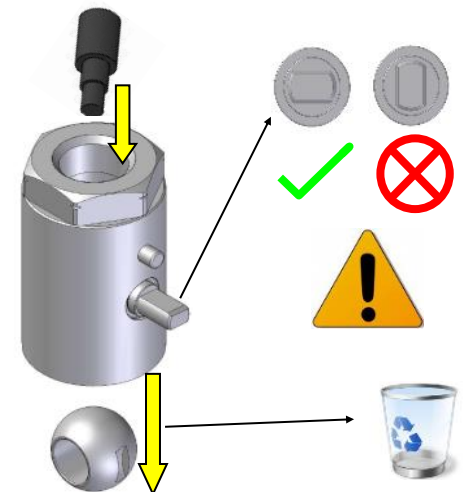

BV703

7. Remove 2nd seat first.

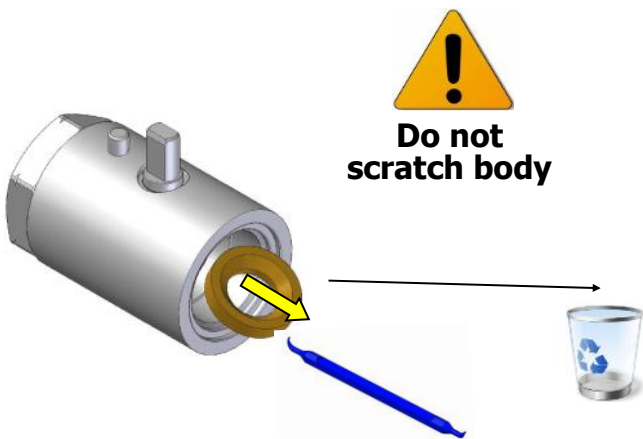

Do not scratch body

BV704 - BV706 - BV708

7. Remove stem first.

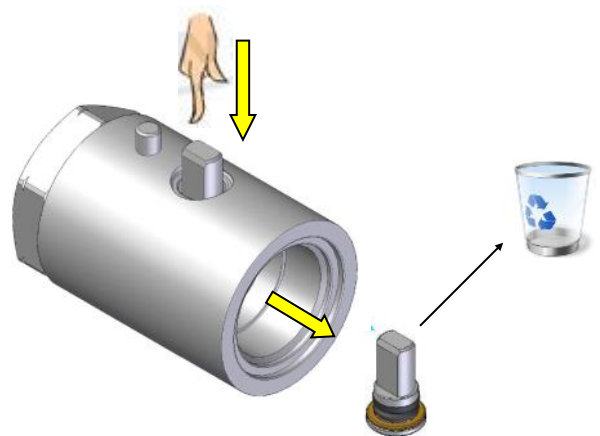

BV703

8. Remove and discard stem.

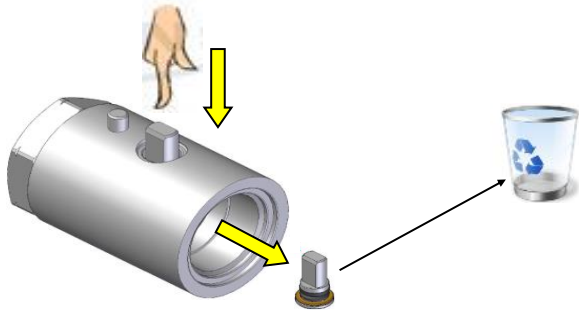

BV704 - BV706 - BV708

8. Remove and discard 2nd seat.

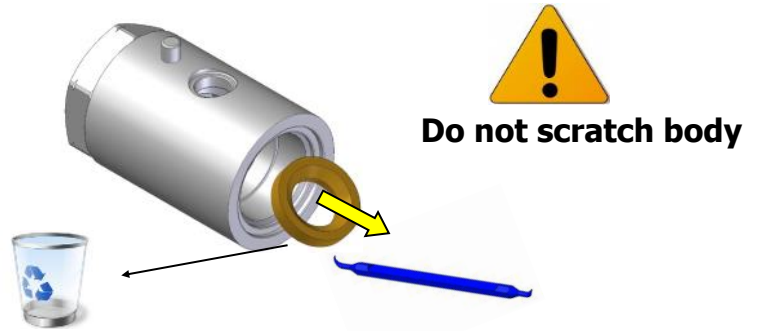

BV703 - BV704

9. Remove cap O-ring and discard.

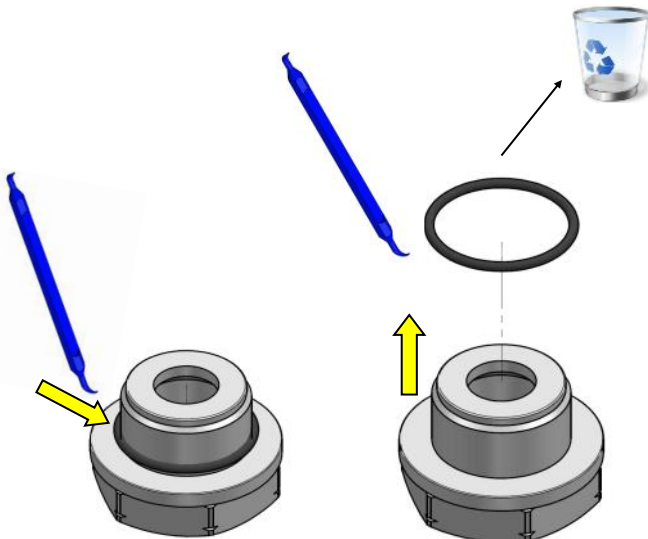

BV706 - BV708

9. Remove cap O-rings and discard.

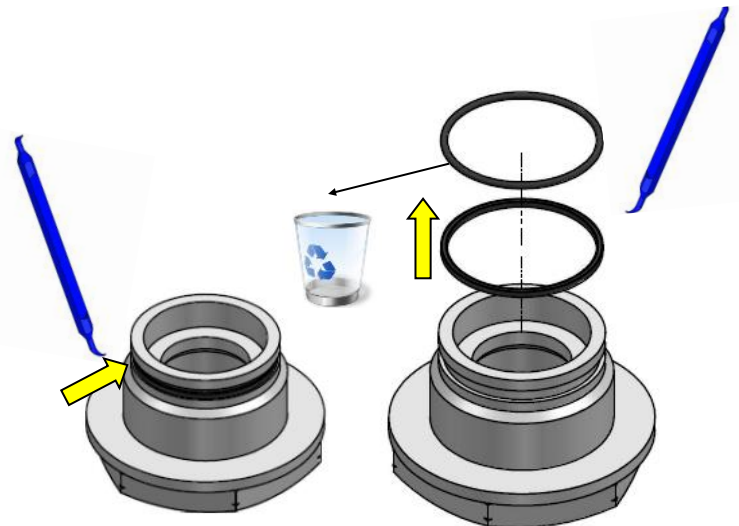

10. Clean body and end cap. Visually inspect parts for damage.

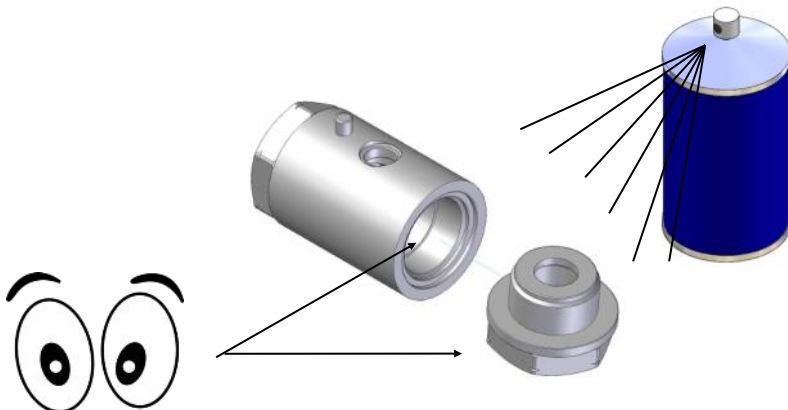

BV703 - BV704

1. Fit O-ring.

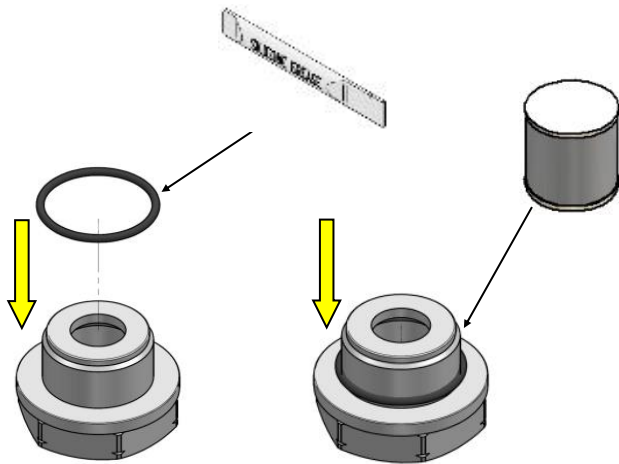

2. Apply silicone grease to new seat and install. Take care not to pinch O-ring when installing low pressure seat.

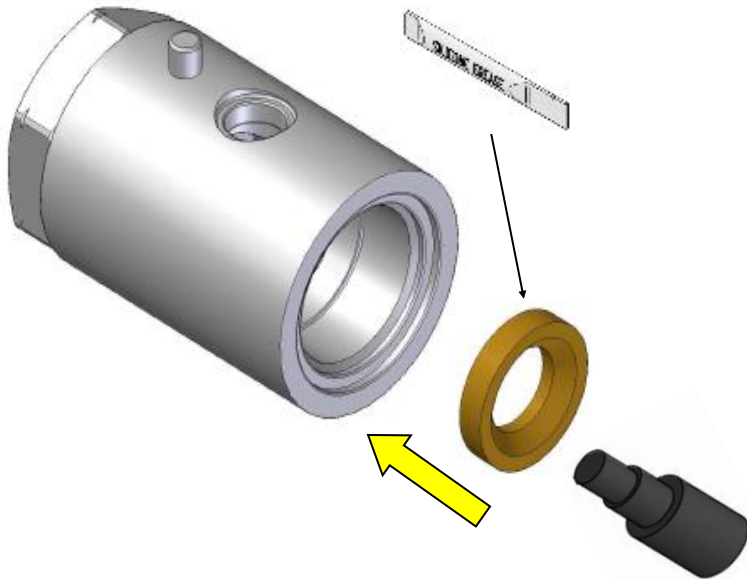

BV706 - BV708

1. Fit end cap O-ring and backup.

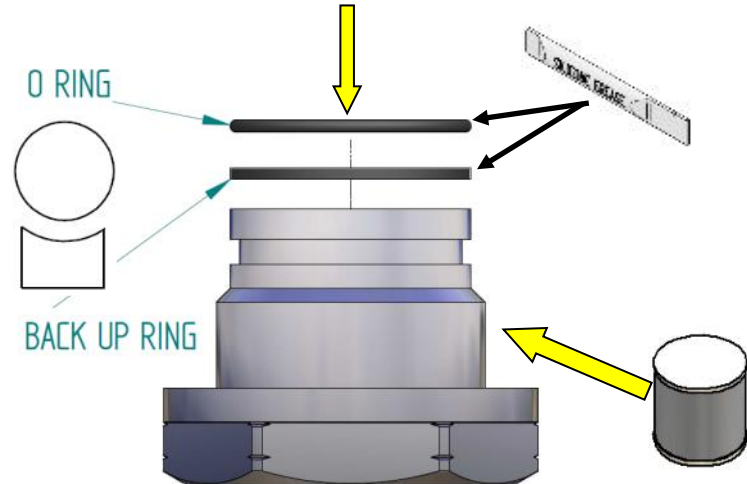

3. Insert stem assembly.

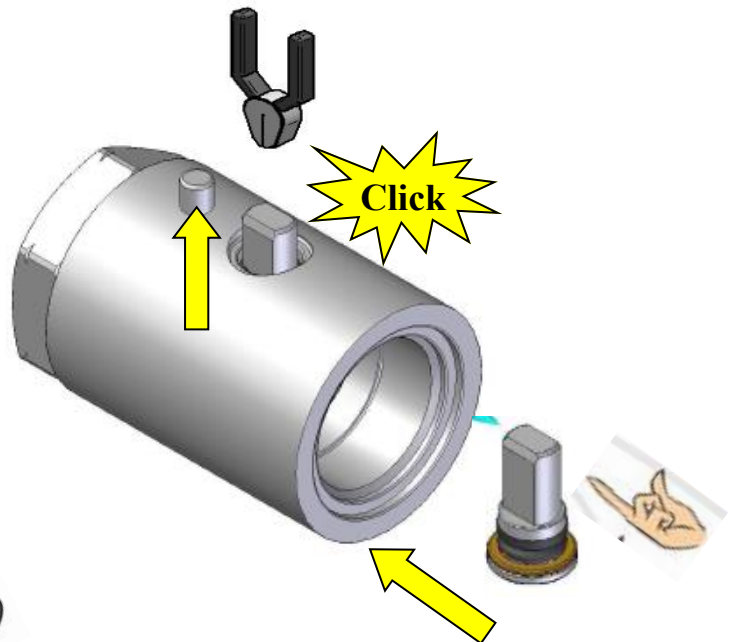

4. Insert ball.

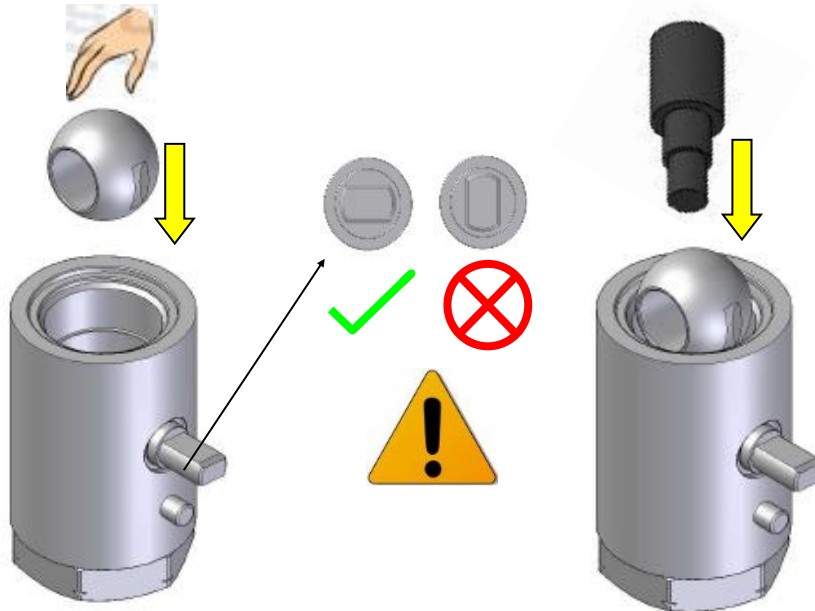

BV703 - BV704

5. Apply silicone grease to new seat and install. Take care not to pinch O-ring when installing low pressure seat.

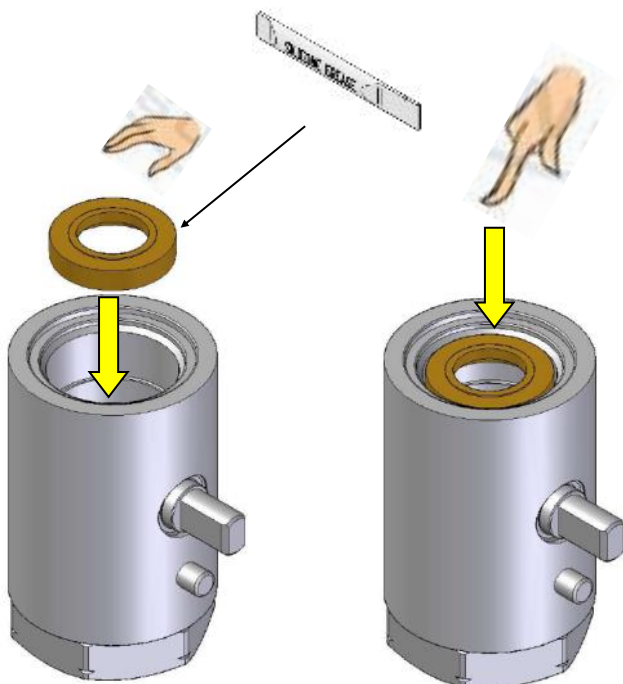

BV706 - BV708

5. Apply silicone grease to new seat and install in cap. Take care not to pinch O-ring when installing low pressure seat.

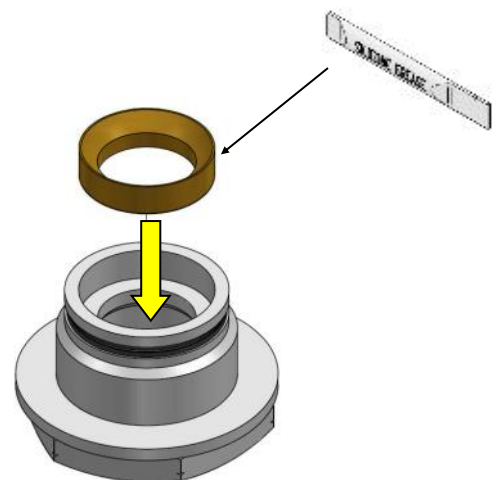

6. Torque tight the end cap.

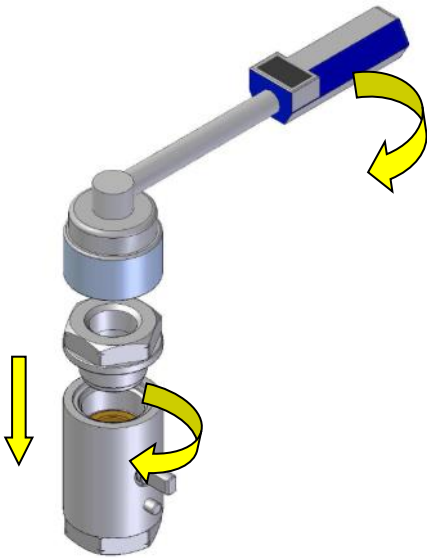

**Recommended
End Cap Torques:**

BV704=60Nm
BV706=120Nm
BV708=120Nm

7. Install gland and screw on handle nut.

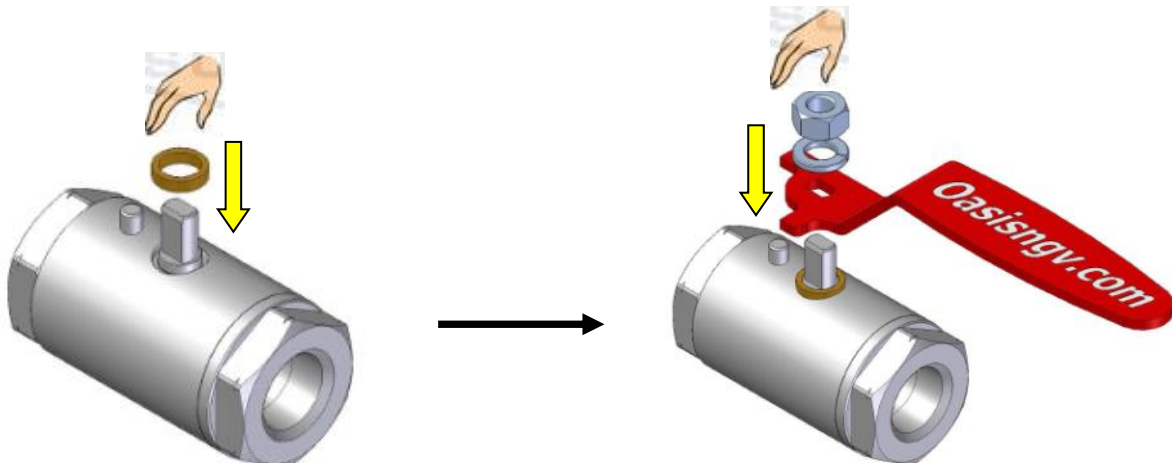

8. Tighten stem nut.

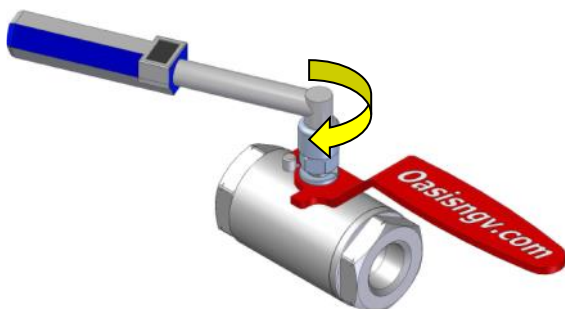

**Recommended
Handle Nut Torques:**

BV704=3Nm
BV706=6Nm
BV708=6Nm

9. Remove SAE O-rings from valve fittings.

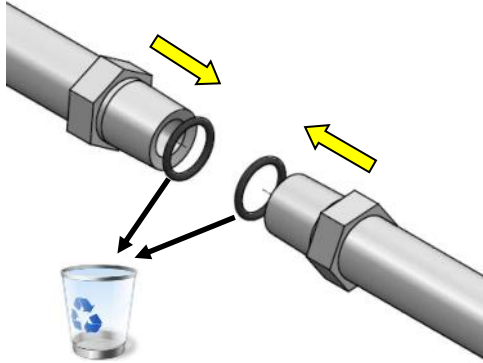

10. Re-attach valve to system with new SAE O-rings supplied.

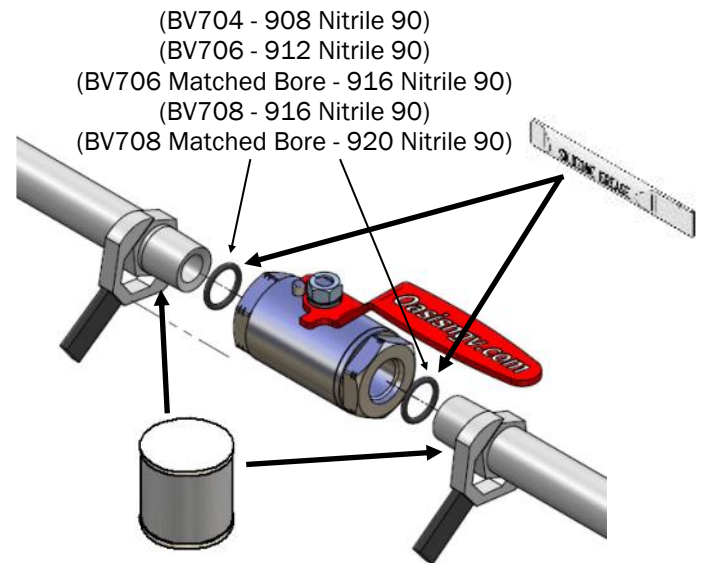

11. Check for leaks on first use using snoop or soapy water.

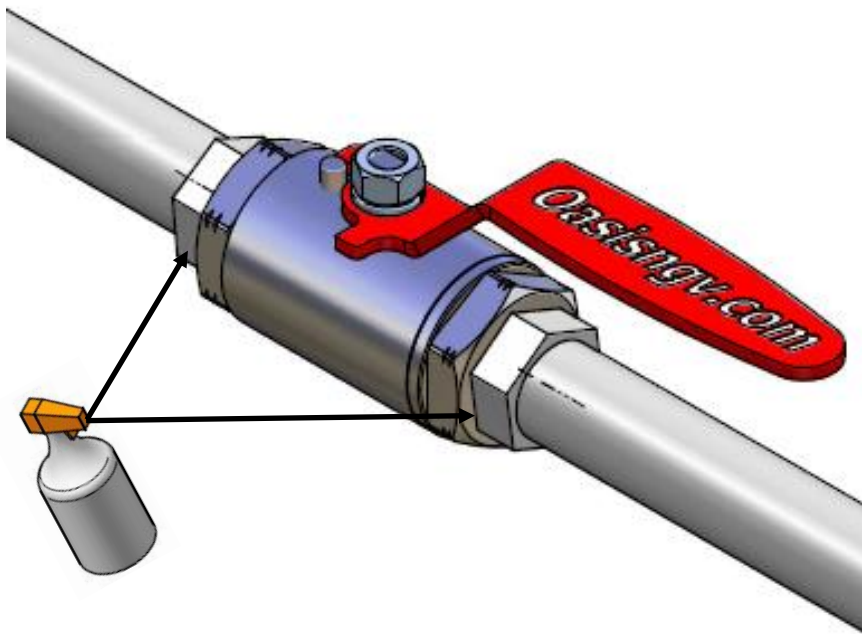

Important: Actuate valve 4 times before use to ensure initial sealing.